

TRACK SYSTEMS

Q-8100-A1

- Heavy duty automatic retractors
- Dual tensioning knobs
- Hard cover case to protect belts
- Belts are interchangeable

Kit includes the following parts:

QTY	DESCRIPTION
4	QRT automatic retractors
1	Adjustable lap/shoulder belt combination
2	Pin connector brackets



11

SPECIAL NEEDS

Q-5001

- Single tensioning knob
- Interchangeable belts
- Self-tensioning
- Speed hooks
- Red release lever

Kit includes the following parts:

QTY	DESCRIPTION
4	QRT Econo Retractors
1	Retractable and adjustable lap/shoulder belt combination
2	Pin connector brackets



Q-5001-5

Kit includes the following parts:

PART NO.	QTY	DESCRIPTION
Q5-6110 (LH) Q5-6111 (RH)	1 ea	Rear belts
Q5-6210 (LH) Q5-6211 (RH)	1 ea	Front belts
Q5-6320	1	Lap belt
Q5-6410	1	Shoulder belt
Q5-6500	1	Shoulder belt bracket assembly
Q5-2941	1	Warranty card
Q5-1160	1	Instructional guide for drivers
Q5-1150	1	Installation instructions
Q5-1140	1	Instruction adhesive label
Q5-7576	1	Optional floor riser

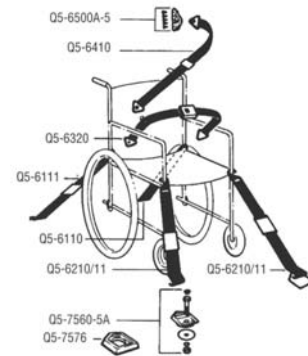

Q-5001-T

Kit includes the following parts:

PART NO.	QTY	DESCRIPTION
Q5-6110-T (LH) Q5-6111-T (RH)	1 ea	Rear belts
Q5-6210-T (LH) Q5-6211-T (RH)	1 ea	Front belts
Q5-6320	1	Lap belt
Q5-6410-T	1	Shoulder belt
Q5-2941	1	Warranty card
Q5-1160	1	Instructional guide for drivers
Q5-1140	1	Instruction adhesive label
Q5-7576	1	Optional Q'Strait Track

Note: Track and hardware to be purchased separately.

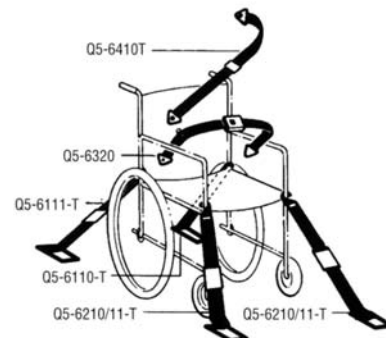

FF627S-4C

- With S-hooks
- Without occupant restraint



Kit includes the following parts:

PART NO.	QTY	DESCRIPTION
FE200855S	2	Right-hand crank retractor assembly with D-ring and S-hook
FE200907S	2	Left-hand crank retractor assembly with D-ring and S-hook

FF627-4C

- With buckle and tab
- Without occupant restraint



Kit includes the following parts:

PART NO.	QTY
FE200855	2
FE200907	2

Newly redesigned cover made of brushed chrome!



SURE-LOK
WHEELCHAIR TIE-DOWNS • OCCUPANT RESTRAINT SYSTEMS

FF628S-4C

- With S-hooks



Kit includes the following parts:

PART NO.	QTY	DESCRIPTION
FE200857S	2	Right-hand crank retractor assembly with D-ring and S-hook
FE200925S	2	Left-hand crank retractor assembly with D-ring and S-hook

FF628-4C

- With buckle and tab



Kit includes the following parts:

PART NO.	QTY
FE200857	2
FE200925	2

WHEELCHAIR RESTRAINTS

L-Track M-Series

- ADA strength test: minimum 2500 lbs. /1131 kg
- Meets FMVSS 209 and 302 standards
- Crash tested 30 mph at 20 Gs or 50 kph at 20 Gs



A-Track and E-Track M-Series

- ADA strength test: minimum 2500 lbs. /1131 kg
- Meets FMVSS 209 and 302 standards
- Crash tested 30 mph at 20 Gs or 50 kph at 20 Gs



MA-410

- Shoulder belt



MA-320

- Lap belt



ML-410

- Shoulder belt



ML-320

- Lap belt



MM-410

- Shoulder belt



Q'Straint

MM-320

- Lap belt



FE501

Kit includes the following parts:

PART NO.	QTY	DESCRIPTION
FE200619	2	Cam buckle straps
FE200620	2	Overcenter buckle straps
FE8264-1	1	Heavy duty series A track fitting

FE501S

- With S-hooks

Kit includes the following parts:

PART NO.	QTY	DESCRIPTION
FE200619LS FE200619RS	2 ea	Cam buckle straps
FE200620LS FE200620RS	2 ea	Overcenter buckle straps
FE8264-1	1	Heavy duty series A track fitting



FE501

SURE-LOK™
WHEELCHAIR ACCESSIBILITY OCCUPANT RESTRAINT SYSTEMS

FE510 1598994

Kit includes the following parts:

PART NO.	QTY	DESCRIPTION
FE200620	4	Overcenter buckle straps
FE8264-1	1	Heavy duty series A track fitting

FE510S

- With S-hooks

Kit includes the following parts:

PART NO.	QTY	DESCRIPTION
FE200620LS FE200620RS	2 ea	Overcenter buckle straps
FE8264-1	1	Heavy duty series A track fitting



FE510

SURE-LOK™
WHEELCHAIR ACCESSIBILITY OCCUPANT RESTRAINT SYSTEMS

FE514

Kit includes the following parts:

PART NO.	QTY	DESCRIPTION
FE200602	2	Cam buckle straps
FE200603	2	Overcenter buckle straps
	1	Heavy duty series L track fitting



FE514



FE514S

- With S-hooks

Kit includes the following parts:

PART NO.	QTY	DESCRIPTION
FE200602RS FE200602LS	2 ea	Cam buckle straps
FE200603RS, FE200603LS	2 ea	Overcenter buckle straps
	1	Heavy duty series L track fitting

FE517

Kit includes the following parts:

PART NO.	QTY	DESCRIPTION
FE200603	4	Overcenter buckle straps
	1	Heavy duty series L track fitting



FE517



FE517S

- With S-hooks

Kit includes the following parts:

PART NO.	QTY	DESCRIPTION
FE200603RS FE200603LS	2 ea	Overcenter buckle straps
	1	Heavy duty series L track fitting

LAP AND SHOULDER BELTS

FE200594

- Series L track
- 98" long

SURE-LOK
WHEELCHAIR TIE-DOWNS™ OCCUPANT RESTRAINT SYSTEMS



FE200601

- Series A track
- 98" long

SURE-LOK
WHEELCHAIR TIE-DOWNS™ OCCUPANT RESTRAINT SYSTEMS



FE200600

- Series L track
- 108" long

SURE-LOK
WHEELCHAIR TIE-DOWNS™ OCCUPANT RESTRAINT SYSTEMS



FE200612

- Series A track
- 108" long

SURE-LOK
WHEELCHAIR TIE-DOWNS™ OCCUPANT RESTRAINT SYSTEMS



FE200595

00016545

- 80" long
- Used with the Sure-lok FE500 series securement systems

00019628

FE200600 Lap Belt Assy
(L Track)

SURE-LOK
WHEELCHAIR TIE-DOWNS™ OCCUPANT RESTRAINT SYSTEMS



FE200727

- Shoulder belt with integrated lap belt
- Series L track
- Used with Sure-lok FE500 series securement systems



SURE-LOK
WHEELCHAIR TIE-DOWNS™ OCCUPANT RESTRAINT SYSTEMS

FE200727HA

- Shoulder belt with integrated lap belt and height adjuster
- Series L track
- Used with Sure-lok FE500 series securement systems



SURE-LOK
WHEELCHAIR TIE-DOWNS™ OCCUPANT RESTRAINT SYSTEMS

FE200599HA

- Shoulder belt with height adjuster
- Series L track
- Non-retractable



SURE-LOK
WHEELCHAIR TIE-DOWNS™ OCCUPANT RESTRAINT SYSTEMS

11

SPECIAL NEEDS

FE200599

- Series L track
- 52" long
- Non-retractable

FE200732

- Series L track
- 82" long
- Non-retractable



SURE-LOK
WHEELCHAIR SEATING • OCCUPANT RESTRAINT SYSTEMS

FE200613

- Series A track
- 52" long
- Non-retractable

FE200716

- Series A track
- 82" long
- Non-retractable



SURE-LOK
WHEELCHAIR SEATING • OCCUPANT RESTRAINT SYSTEMS

FE200710

- Fixed-point shoulder belt
- 52" long
- Non-retractable

FE200710L

- Fixed-point shoulder belt
- 82" long
- Non-retractable



SURE-LOK
WHEELCHAIR SEATING • OCCUPANT RESTRAINT SYSTEMS

FE200710HA

- Fixed-point shoulder belt with height adjuster
- Non-retractable



SURE-LOK
WHEELCHAIR SEATING • OCCUPANT RESTRAINT SYSTEMS

FE200604

- Shoulder belt
- 112" long
- Retractable

FE200604L

- Shoulder belt
- 136" long
- Retractable



SURE-LOK
WHEELCHAIR SEATING • OCCUPANT RESTRAINT SYSTEMS

FE200604HA

- Shoulder belt with height adjuster
- Retractable



SURE-LOK
WHEELCHAIR SEATING • OCCUPANT RESTRAINT SYSTEMS

TRACKS AND FLOOR PLATES

FE750-01

- Series L track
- Medium-duty
- Aluminum
- Natural finish
(also available in black finish)
- 5.0 lb/2.3 kg
- 100 in/3 m

SURE-LOK
WHEELCHAIR ACCESSIBLE TRACKING SYSTEM

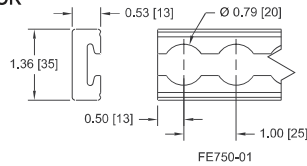
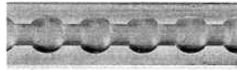

FE748-01-PD4

- Series L track with flanges and mounting holes
- Heavy-duty
- Aluminum
- Natural finish
(also available in black finish)
- 5.4 lb/2.5 kg
- 100 in/3 m

SURE-LOK
WHEELCHAIR ACCESSIBLE TRACKING SYSTEM

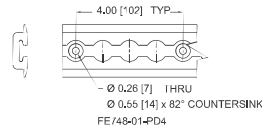

FE752-01

- Series L track, angled
- Medium-duty
- Aluminum
- Natural finish
(also available in black finish)
- 5.2 lb/2.4 kg
- 100 in/3 m

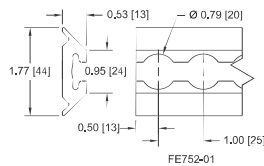

(Photo not available)

SURE-LOK
WHEELCHAIR ACCESSIBLE TRACKING SYSTEM

FE751-01-PD4

- Series L track with flanges and mounting holes
- Medium-duty
- Aluminum
- Natural finish
(also available in black finish)
- 5.2 lb/2.4 kg
- 100 in/3 m

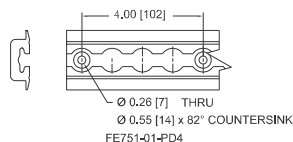

SURE-LOK
WHEELCHAIR ACCESSIBLE TRACKING SYSTEM

FE744-01

- Series L track
- Heavy-duty
- Aluminum
- Natural finish
(also available in black finish)
- 5.2 lb/2.4 kg
- 100 in/3 m

SURE-LOK
WHEELCHAIR ACCESSIBLE TRACKING SYSTEM

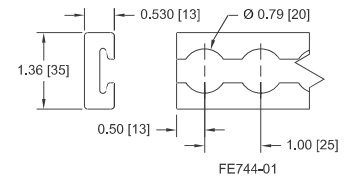

FE200761

- 8" section with 4 countersunk holes (.26)

FE200762

- 9" section with 2 holes (.42)

FE751-01

- Series L track with flanges
- Medium-duty
- Aluminum
- Natural finish
(also available in black finish)
- 5.4 lb/2.5 kg
- 100 in/3 m

SURE-LOK
WHEELCHAIR ACCESSIBLE TRACKING SYSTEM

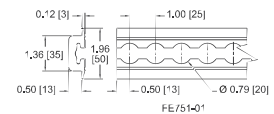

FE748-01

- Series L track with flanges
- Heavy-duty
- Aluminum
- Natural finish
(also available in black finish)
- 5.6 lb/2.6 kg
- 100 in/3 m

SURE-LOK
WHEELCHAIR ACCESSIBLE TRACKING SYSTEM

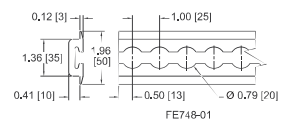

FE200763

- 8" section with 4 countersunk holes (.26)

FE200765

- 9" section with 2 holes (.42)

11

SPECIAL NEEDS

03354

Q5-6008-FPD

- 6000 series flanged track
- 8" long
- Pre-drilled 5/16"/7.793 mm.



Q5-6008-FBK

- 6000 series flanged track
- 8" long
- Black anodized finish
- Pre-drilled 5/16"/7.793 mm.



Q5-7008-F

- 7000 series flanged track
- 8" long
- Pre-drilled 5/16"/7.793 mm.



Q5-7008-FBK

- 7000 series flanged track
- 8" long
- Black anodized finish
- Pre-drilled 5/16"/7.793 mm.



Q5-7008-PD

- 7000 series non-flanged track
- 8" long
- Pre-drilled 5/16"/7.937 mm.



Q5-6008-PD

- 6000 series non-flanged track
- 8" long
- Pre-drilled 5/16"/7.937 mm.

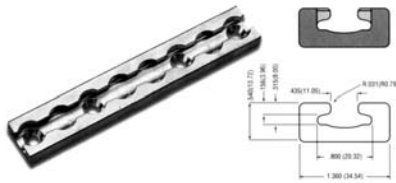

Q5-6008-SRPD

- 6000 series surface rail
- 8" long
- Pre-drilled 5/16"/7.937 mm.

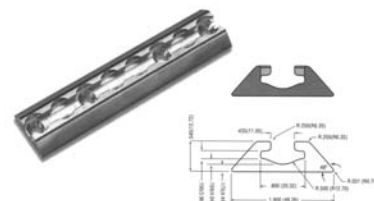

FE200784

- Series L
- Single bolt
- Surface mount with collar and mounting hardware
- Impact-resistant plastic
- High strength plated steel track
- 1.0 lb/0.45 kg

SURE-LOK



FE200844

- Series L
- Single bolt
- Flush mount with mounting hardware
- Stainless steel case
- High strength plated steel track
- 1.0 lb/0.45 kg

SURE-LOK



MA-7560

- Floor plate
- Heavy-duty
- Heat treated



CHILD SAFETY RESTRAINT SYSTEMS

Q5-6400-01-S

- Q'Vest
- Fits 20-60 lbs.

Q5-6400-01-L

- Q'Vest
- Fits 60 lbs. and over



11

SPECIAL NEEDS

BR-22AI

- Restraining harness
- Fits waist sizes 22" to 28"
- Brown

BR-30AI

- Restraining harness
- Fits waist sizes 30" to 36"
- Maroon

BR-38AI

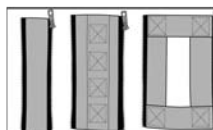
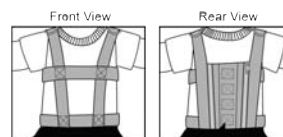

- Restraining harness
- Fits waist sizes 38" to 44"
- Grey



Each harness comes with 3 separate zipper inserts that give you the ability to adjust to any size child!

Q5-T

- Training program

E-Z-ON™ PRODUCTS

100AR

- Ankle restraints
- 3 push-buckle closures
- One-pull adjustment

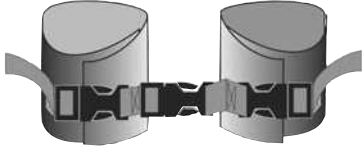

100NP

- Sherpa neck pads
- 8" standard length
- 12" optional length



E-Z-ON™ PRODUCTS

E-Z-ON™ PRODUCTS

100BG

- Buckle guard

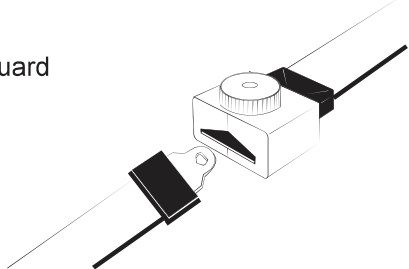

100AZ

- Zipper inserts
- Available in 4 sizes

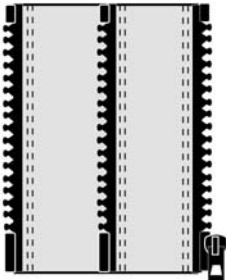

E-Z-ON™ PRODUCTS

4012

- Locking clip



E-Z-ON™ PRODUCTS

100WRP

- Wrist restraints
- Push buckle closure
- One-pull adjustment

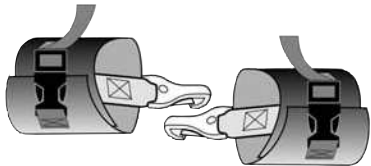

E-Z-ON™ PRODUCTS

100CRP

- Crotch straps

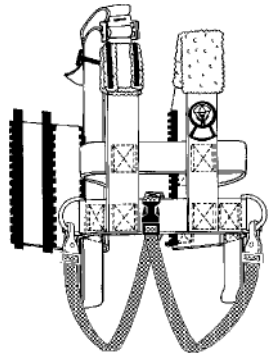

E-Z-ON™ PRODUCTS

CR-30

- Integrated child restraint seat
- 30" single seat
- 56 lbs.

CR-39

- Integrated child restraint seat
- 39" double seat
- 73 lbs.



C. E. White Co.

00052977

- Seat belt assembly
- Bus-baby
- Reverse 90° mount
- Turquoise
- Blue Bird applications

00052978

- Seat belt assembly
- Bus-baby
- Reverse 30° mount
- Turquoise
- AmTran, Collins applications

00052979

- Seat belt assembly
- Bus-baby
- Flat mount
- Turquoise
- Thomas, Carpenter applications

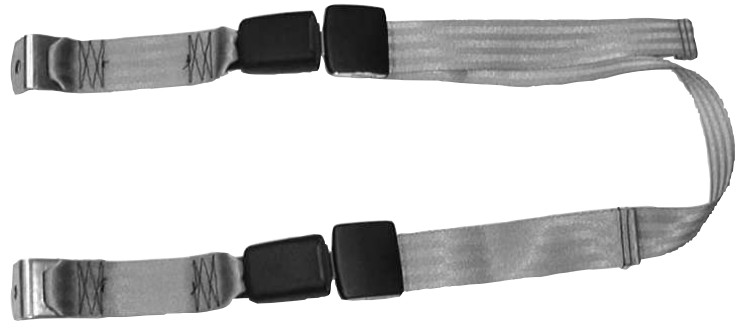

Don't wrestle with conventional seat belts to secure your child's safety seat.

Try the "Bus Baby Belt" instead!

It's the perfect belt to securely tie down child safety seats.

With twin adjustable tongues, the easy-to-use "Bus Baby Belt" is the perfect solution for securing a child safety seat.

It's the difference you can trust!

OTHER ACCESSORIES

00040264

- 172" Seat Belt, 3pt Susp

01497528

- 10" Longer Lap Belt
- 88" Floor to Floor

04301917

- Tether, Driver's



FE200745

- Sidewall mounting kit

For use with the following:

FE200604

- Retractable shoulder belt

FE200727

- Integrated combination belt

FE200710

- Fixed-point shoulder belt



FE200744

- Series L seat stud fitting

For use with the following:

FE744-01

- Heavy-duty series L track

SURE-LOK

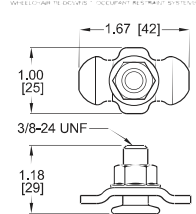

FE200747

- Series L mounting kit

For use with the following:

FE200604

- Retractable shoulder belt

FE200727

- Integrated combination belt

SURE-LOK

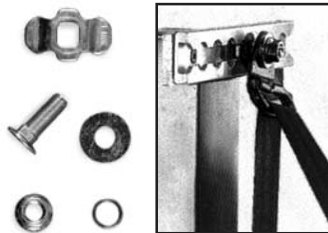

FE200751

- Plastic filler strip
- Used with series L aluminum track
- Available in 25 ft. rolls

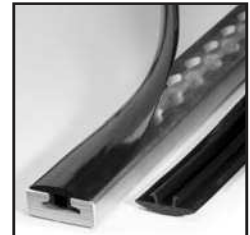

SURE-LOK

FE200750

- Quick strap

SURE-LOK



8663

- End cap
- Used with series L aluminum flanged track (FE748 or FE751)

SURE-LOK



Q5-7551-TF

- End cap
- Flange track
- Black



Q5-7551-TFS

- End cap
- Flange track
- Silver

Q5-7551-SR

- End cap
- Surface rail
- Black



Q5-7551-SRS

- End cap
- Flange track
- Silver



Q5-3053

- End cap
- Flange track
- Black



Q5-6300

- Lap cable extension



Q5-7570-A

- Covered track pocket
- Cast stainless steel
- Used with "L" track fitting

Image Not Available



Q5-6500-L

- Mounting hardware
- "L" track
- Four (4) per wheelchair location required
- Includes (1) "L" track fitting and (1) bracket and hardware



Q5-7535-A

- Heavy-duty
- Seat fitting stud
- Long wing



Q5-7535-A-S

- Heavy-duty
- Seat fitting stud
- Short wing



Q5-7535-A-K

- Seat fitting stud
- Hand operated



Q5-7550-T

- Track cover
- Available in black or silver



Q8-6040-FS-A

- Slider track
- Flange
- Pre-drilled, front or rear
- Used with Q8-6500-L track fitting and the QRT



8705

- Premium web cutter

SURE-LOK**Q5-7560-5A**

- Floor pocket assembly
- Flush-mounted
- Stainless steel
- Used with QRT or Q-5000 series systems

**Q5-7590**

- Belt cutter

**Q5-8522**

- Wall pouch
- Mesh material

**Q5-7576**

- Floor pocket riser
- Plastic
- Fits with p/n Q5-7560-5A

**FE200746**

- Vinyl storage container

SURE-LOK**Q5-7570-5**

- Rubber plug

**Q5-8521-T**

- Wheelchair tray pouch

**Q5-7530**

- Washer
- 3-hole
- 4"/102 mm



